



## 1.3 Surface heating and cooling

### **Heating circuit distributors/ collectors for surface heating and surface cooling** **147**

---

Multidis SF Heating circuit distributors/collectors for surface heating and surface cooling.....	148
Multidis SFQ Heating circuit distributors/collectors with Q-Tech.....	149
Multidis SFI Distributors/collectors for industrial surface heating / cooling and concrete core activation..	150
Heat meter connection sets.....	152
Multidis - Accessories and spare parts.....	154

# Multidis SF Heating circuit distributors/collectors for surface heating and surface cooling



The **Multidis SF** heating circuit distributors/collectors for surface heating and cooling for 2 - 12 heating circuits are made of stainless steel. The flow distributor is equipped with integrated regulating inserts or with integrated flow measuring and regulating devices. The return collector is equipped with valve inserts with an M 30 x 1.5 connection thread to connect optional actuators. The heating circuit distributors/collectors are completely pre-as-

sembled with fill and drain cocks, vent plugs and end caps. The heating circuit connections with G 3/4 external thread are suitable for Oventrop compression fittings. Wall brackets are loosely enclosed. Sound insulation according to DIN 4109. The heating circuit distributors/collectors are designed for use in surface heating and cooling system with forced circulation.

Body material	Stainless steel	With valve inserts	Yes
Connection thread heating circuits	G 3/4 external	Heating circuits can be shut off	Yes
Connection thread supply and return	G 1 internal thread	Ball valve	No
Fill and drain cock	Yes	Wall bracket	Yes

## Multidis SF with integrated regulating inserts in the flow distributor



Max. operating pressure (bar)	Heating circuits	Operating temperature (°C)	Item No.
10	2	-10 up to 90	1406552
10	3	-10 up to 90	1406553
10	4	-10 up to 90	1406554
10	5	-10 up to 90	1406555
10	6	-10 up to 90	1406556
10	7	-10 up to 90	1406557
10	8	-10 up to 90	1406558
10	9	-10 up to 90	1406559
10	10	-10 up to 90	1406560
10	11	-10 up to 90	1406561
10	12	-10 up to 90	1406562

## Multidis SF with integrated flow measuring and regulating devices in the flow distributor



Max. operating pressure (bar)	Heating circuits	Control range (l/min)	Operating temperature (°C)	Item No.
6	2	0 up to 5	-10 up to 70	1406352
6	3	0 up to 5	-10 up to 70	1406353
6	4	0 up to 5	-10 up to 70	1406354
6	5	0 up to 5	-10 up to 70	1406355
6	6	0 up to 5	-10 up to 70	1406356
6	7	0 up to 5	-10 up to 70	1406357
6	8	0 up to 5	-10 up to 70	1406358
6	9	0 up to 5	-10 up to 70	1406359
6	10	0 up to 5	-10 up to 70	1406360
6	11	0 up to 5	-10 up to 70	1406361
6	12	0 up to 5	-10 up to 70	1406362

# Multidis SFQ Heating circuit distributors/collectors with Q-Tech



The **Multidis SFQ** heating circuit distributors/collectors for surface heating and cooling for 2 - 12 heating circuits are made of stainless steel. The flow distributor is equipped with integrated flow indicators or with integrated shutoff devices. The return collector is equipped with QM valve inserts with an M 30 x 1.5 connection thread to connect optional actuators. The special QM valve insert allows for automatic hydronic balancing in central heating and cooling systems with closed circuits.

The heating circuit distributors/collectors are completely pre-assembled with fill and drain cocks, vent plugs and end caps. The heating circuit connections with G 3/4 external thread are suitable for Oventrop compression fittings. Wall brackets are loosely enclosed. Sound insulation according to DIN 4109. The heating circuit distributors/collectors are designed for use in surface heating and cooling system with forced circulation.

Body material	Stainless steel	Fill and drain cock	Yes
Connection thread heating circuits	G 3/4 external	With valve inserts	Yes
Connection thread supply and return	G 1 internal thread	Heating circuits can be shut off	Yes
Q-Tech*	Yes	Presetting key enclosed	Yes
Flow rate indicator	Yes	Ball valve	No
		Wall bracket	Yes

## Multidis SFQ with integrated flow indicators in the flow distributor



Heating circuits	Flow indicator	Operating temperature (°C)	Item No.
2	Yes	2 up to 60	1404952
3	Yes	2 up to 60	1404953
4	Yes	2 up to 60	1404954
5	Yes	2 up to 60	1404955
6	Yes	2 up to 60	1404956
7	Yes	2 up to 60	1404957
8	Yes	2 up to 60	1404958
9	Yes	2 up to 60	1404959
10	Yes	2 up to 60	1404960
11	Yes	2 up to 60	1404961
12	Yes	2 up to 60	1404962



# Multidis SFI Distributors/collectors for industrial surface heating / cooling and concrete core activation



The **Multidis SFI** distributors/collectors for industrial surface heating and cooling as well as concrete core activation for 2 - 6 circuits are made of brass. The flow distributor is equipped with ball valves and the return collector with regulating valves. An extension of the circuits up to 20 is possible by connecting

distributor/collector modules. Flow distributor with G 1 external thread for Oventrop compression fittings. Return collector with integrated regulating valves with G 1 external thread. The distributors/collectors are designed for use in industrial surface heating and cooling systems as well as for concrete core activation.



## Multidis SFI

Body material	Brass	With regulating valves	Yes
Connection thread heating circuits	G 1 external thread	Heating circuits can be shut off	Yes
Connection thread supply and return	G 2 union nut x G 2 external thread	Ball valve	No
Q-Tech*	No	Extendable	Yes
Fill and drain cock	No	Wall bracket	No

Heating circuits	Operating temperature (°C)	Max. operating pressure (bar)	Item No.
2	2 up to 90	6	1414452
3	2 up to 90	6	1414453
4	2 up to 90	6	1414454
5	2 up to 90	6	1414455
6	2 up to 90	6	1414456

## PE-Xc Copex Plastic pipe

With oxygen barrier.



Description	Item No.
20 x 2.0 mm, length per roll: 240 m	1400352
20 x 2.0 mm, length per roll: 600 m	1400354
26 x 3.0 mm, length per roll: 50 m	1400560
26 x 3.0 mm, length per roll: 200 m	1400562
26 x 3.0 mm, length per roll: 300 m	1400563
32 x 3.0 mm, length per roll: 50 m	1400660



### Cofit S Compression fitting



#### Description

20 x 2.0 mm x G 1 union nut  
26 x 3.0 mm x G 1 union nut

#### Item No.

1507969  
1507979

### Wall bracket



#### Description

For Multidis SFI for industrial surface heating/cooling and concrete core activation steel, galvanised, height and depth adjustable, 2-fold with two pipe clamps including sound insulation inserts and quick fastener

#### Item No.

1414490

### Cap



#### Description

For Multidis SFI for industrial surface heating/cooling and concrete core activation brass, G 2 internal thread, 2-fold

#### Item No.

1414493

### Ball valve



#### Description

For Multidis SFI for industrial surface heating/cooling and concrete core activation, DN 50, G 2 internal thread x G 2 external thread

#### Item No.

1406586

### Optiflex Ball valve



#### Description

For Multidis SH/SF/SFQ/SFI, for filling and venting, DN 15, G 1/2

#### Item No.

1033314

# Heat meter connection sets



Heat meter connection sets are matched for use with Multidis heating circuit distributors/collectors for surface heating and cooling.

Commercially available heat meters with flat

sealing housings with the following dimensions can be retrofitted in the return pipe:  
- Length 110 mm and G 3/4 external thread  
- Length 130 mm and G 1 external thread



## Heat meter connection set for Multidis SF with Hycocon VTZ

**Description**

- With Hycocon VTZ DN 20 , angle, ball valves DN 20
- With Hycocon VTZ DN 20 , angle, ball valves DN 25
- With Hycocon VTZ DN 20 , straight, ball valves DN 20
- With Hycocon VTZ DN 20 , straight, ball valves DN 25

**Item No.**

- 1404578
- 1404580
- 1404579
- 1404581



## Heat meter connection set for Multidis SF with Hycocon DTZ

**Description**

- with Hycocon DTZ DN 20, angle, ball valves DN 25
- with Hycocon DTZ DN 20, straight, ball valves DN 25

**Item No.**

- 1404682
- 1404683



## Heat meter connection set for Multidis SF with Cocon QDP

**Description**

- With Cocon QDP DN 20 (up to 1,350 l/h), angle, ball valves DN 20
- With Cocon QDP DN 20 (up to 1,350 l/h), angle, ball valves DN 25
- With Cocon QDP DN 20 (up to 1,350 l/h), straight, ball valves DN 20
- With Cocon QDP DN 20 (up to 1,350 l/h), straight, ball valves DN 25

**Item No.**

- 1404884
- 1404886
- 1404885
- 1404887



**Heat meter connection set for Multidis SFQ with ball valves**

Description	Item No.
With ball valves DN 20, angle	1405578
With ball valves DN 25, angle	1405580
With ball valves DN 20, straight	1405579
With ball valves DN 25, straight	1405581



# Multidis - Accessories and spare parts



## Cofit S Compression fitting for G 3/4 external thread

According to DIN EN 16313, clamping ring and union nut made of brass, union nut nickel plated, outlet made of bronze, metal to metal sealing plus O-ring.  
Suitable for Copipe multi-layer composite pipes and, with the same processing method, also for plastic pipes.

Description	Item No.
14 x 2.0 mm x G 3/4 union nut, 1-fold	1507954 °
14 x 2,0 mm x G 3/4 union nut, 2-fold	1507934
16 x 2.0 mm x G 3/4 union nut, 1-fold	1507955 °
16 x 2.0 mm x G 3/4 union nut, 2-fold	1507935
17 x 2.0 mm x G 3/4 union nut, 2-fold	1507937
18 x 2.0 mm x G 3/4 union nut, 2-fold	1507938
20 x 2.0 mm x G 3/4 union nut, 2-fold	1507939
20 x 2.5 mm x G 3/4 union nut, 2-fold	1507940



## Ofix K for G 3/4 external thread

2-fold, for plastic pipes according to DIN EN 4726, PE-X according to DIN 16892/16893, PB according to DIN 16968 and PP according to DIN 8078 A1, metal to metal sealing plus O-ring.

Description	Item No.
12 x 1.1 mm, 2-fold	1016883
12 x 2.0 mm, 2-fold	1016870
14 x 2.0 mm, 2-fold	1016873
15 x 2.5 mm, 2-fold	1016885
16 x 1.5 mm, 2-fold	1016882
16 x 2.0 mm, 2-fold	1016874
17 x 2.0 mm, 2-fold	1016876
18 x 2.0 mm, 2-fold	1016877
20 x 2.0 mm, 2-fold	1016879



## Double fitting (2-fold)

Description	Item No.
For heat meter connection sets, G 1 external thread x G 1 union nut	1699085



## Coupling

Description	Item No.
For connecting two Multidis SF heating circuit distributors/collectors, G 1 x G 3/4	1407206



## Coupling

Description	Item No.
DN 15, G 3/4 union nut x R 1/2 external thread, brass, nickel plated	1019304





### Surface-mounted cabinet

For Multidis SF/SFQ heating circuit distributors.  
Steel, galvanised. Frame and door white lacquered.

#### Description

Description	Item No.
No. 1, W 600 x H 760-870 x D 160 mm	1401171
No. 2, W 750 x H 760-870 x D 160 mm	1401172
No. 3, W 1000 x H 760-870 x D 160 mm	1401173
No. 4, W 1250 x H 760-870 x D 160 mm	1401174



### Flush-mounted cabinet

For Multidis SF/SFQ heating circuit distributors/collectors.  
Steel, galvanised. Frame and door white lacquered. With removable screen.

#### Description

Description	Item No.
No. 1, W 560 x H 760-885 x D 115-180 mm	1401151
No. 2, W 700 x H 760-885 x D 115-180 mm	1401152
No. 3, W 900 x H 760-885 x D 115-180 mm	1401153
No. 4, W 1200 x H 760-885 x D 115-180 mm	1401154

When using heat meter connection sets, the sum of installation length and distributor/collector length must be taken into account

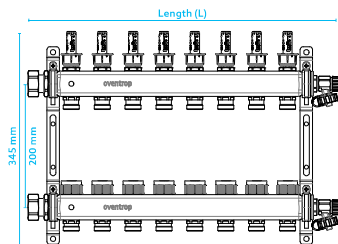

Outlets	Length (L)	Cabinet no.	Length (L) with ball valve item no.1406383	Cabinet no.
2	205 mm	1	255 mm	1
3	255 mm	1	305 mm	1
4	305 mm	1	355 mm	1
5	355 mm	1	405 mm	1
6	405 mm	1	455 mm	1
7	455 mm	1	505 mm	2
8	505 mm	2	555 mm	2
9	555 mm	2	605 mm	2
10	605 mm	2	655 mm	3
11	655 mm	3	705 mm	3
12	705 mm	3	755 mm	3

### Mounting compensation



#### Description

For mounting the Multidis heating circuit distributors/collectors in the cabinet if the piping does not allow it to be mounted at the intended location

#### Item No.

1408015 ☐☐

### Cylinder lock



#### Description

With key for surface-mounted cabinets (item no. 1401171-74)

With key for flush-mounted cabinets (item no. 1401151-54) and all Regudis W cabinets

#### Item No.

1401190

1401191



**Angle connection set**

For bottom connection to heating circuit distributors/collectors when using surface-mounted cabinets.



**Description**

For Multidis SF/SFQ heating circuit distributors/collectors

**Item No.**

1404780

**Ball valve, flat sealing**



**Description**

For Multidis SH/SF/SFQ heating circuit distributors/collectors, DN 20

For Multidis SH/SF/SFQ heating circuit distributors/collectors, DN 25

**Item No.**

1406383

1406384

**Ball valve, flat sealing, with red T-handle and thermometer**



**Description**

For Multidis SH/SF/SFQ heating circuit distributors/collectors, DN 20

For Multidis SH/SF/SFQ heating circuit distributors/collectors, DN 25

**Item No.**

1406483

1406484

**Ball valve, flat sealing, with blue T-handle and thermometer**



**Description**

For Multidis SH/SF/SFQ heating circuit distributors/collectors, DN 20

For Multidis SH/SF/SFQ heating circuit distributors/collectors, DN 25

**Item No.**

1406583

1406584

**Ball valve, flat sealing, with temperature sensor connection M 10 x 1.0**



**Description**

For Multidis SH/SF/SFQ heating circuit distributors/collectors, DN 25

**Item No.**

1406708

**Ball valve with Eurocone**

For shutting off the heating circuits at the distributor/collector.



**Description**

For Multidis SH/SF/SFQ heating circuit distributors/collectors, G 3/4 external thread x G 3/4 union nut

**Item No.**

1406504

**Optiflex Fill and drain ball valve**

Self-sealing, with counter nut, hose screw connection (soft sealing) and cap.



**Description**

For Multidis SH/SF/SFQ/SFI, for filling and venting, DN 15, G 1/2

**Item No.**

1033314

**Differential pressure relief device**

For the right hand side connection to the heating circuit distributor/collector. To avoid flow noises.



**Description**

For Multidis SF heating circuit distributors/collectors, G 3/4 external thread

**Item No.**

1404790

**Vent plug**



**Description**

G 3/8, self-sealing, set = 10 pieces, for heating circuit distributors/collectors (manufactured until 2021)

**Item No.**

1400392

**Cap**



**Description**

G 3/4 internal thread

G 1 internal thread

**Item No.**

1400692

1400693



### Thermometer

#### Description

For brass heating circuit distributors/collectors

#### Item No.

1404095

### Ring spanner



#### Description

For mounting the compression fittings, spanner size 30/32 mm

#### Item No.

1401091



### Replacement valve insert

#### Description

For Multidis SF heating circuit distributors/collectors

For Multidis SFQ heating circuit distributors/collectors

#### Item No.

1404091

1408023



### Replacement flow measuring and regulating device

#### Description

For Multidis SF heating circuit distributors/collectors (manufactured from 2021)

For Multidis SF heating circuit distributors/collectors (manufactured until 2021)

#### Item No.

1408038

1408050



### Replacement flow indicator

#### Description

For Multidis SFQ heating circuit distributors/collectors (manufactured from 2021)

#### Item No.

1408040



### Replacement fill and drain cock

#### Description

For Multidis SF/SFQ heating circuit distributors/collectors (manufactured from 2021)

#### Item No.

1408006



### Replacement wall bracket

#### Description

For Multidis SF/SFQ heating circuit distributors/collectors, with two pipe clamps, including sound insulation, 1-fold

#### Item No.

1408010



**Replacement differential pressure regulator**

**Description**

For heat meter connection sets with Hycocon DTZ, DN 20, G 1 external thread, with measuring and drain valve

**Item No.**

1062166



**Replacement electrothermal actuator, connection thread M 30 x 1.5**

**Description**

Two point control, "normally closed", 24 V

**Item No.**

1012416



## 1.3 Surface heating and cooling

### **Pipes and laying systems** **160**

Copert Plastic pipes.....	161
.....	162
Copipe HSC Multi-layer composite pipes.....	163
Cofloor Tacker system.....	164
Cofloor Base mat system.....	166
Cofloor Thin-layer system.....	169
Cofloor Velcro system.....	171
Cofloor Drywall construction system.....	173
Cofloor - Accessories and spare parts.....	175

# Copert Plastic pipes



The plastic pipes **Copex** (PE-Xc) and **Copert** (PE-RT) are suitable for surface heating and cooling. The **Copex** pipes comply with DIN 16892 / DIN 16893 / DIN EN ISO 15 875 / EN1264-4. The **Copert** pipes comply with DIN 16833 / DIN 16834. Both pipes are oxygen tight according to DIN 4726. The following dimensions are available: 12 x 2.0 mm, 14 x 2.0 mm, 16 x 2.0 mm, 17 x 2.0 mm, 20 x 2.0 mm, 26 x 3.0 mm and 32 x 3.0 mm.

Pipe colour	White	Material outer layer	Plastic
Oxygen tight	Yes	Number of layers	5
Material inner layer	Plastic	Quality class	PE-RT II
Material intermediate layer	Plastic		

## PE-RT Copert Plastic pipe



Dimension (mm)	Length of roll (m)	Max. operating pressure (pipe)	Item No.
12 x 2.0	200	6 bar at 70°C	1401952
14 x 2.0	240	6 bar at 70°C 10 bar at 60°C	1402052
14 x 2.0	600	6 bar at 70°C 10 bar at 60°C	1402054
16 x 2.0	240	6 bar at 70°C 10 bar at 60°C	1402152
16 x 2.0	600	6 bar at 70°C 10 bar at 60°C	1402154
17 x 2.0	240	6 bar at 70°C 10 bar at 60°C	1402252
17 x 2.0	600	6 bar at 70°C 10 bar at 60°C	1402254
20 x 2.0	240	6 bar at 70°C 10 bar at 60°C	1402352



Pipe colour	Natural	Material outer layer	Plastic
Oxygen tight	Yes	Number of layers	5
Material inner layer	Plastic	Quality class	PE-Xc
Material intermediate layer	Plastic		



Dimension (mm)	Length of roll (m)	Max. operating pressure (pipe)	Item No.
14 x 2.0	120	6 bar at 90°C 10 bar at 60°C	1400051
14 x 2.0	240	6 bar at 90°C 10 bar at 60°C	1400052
14 x 2.0	600	6 bar at 90°C 10 bar at 60°C	1400054
16 x 2.0	120	6 bar at 90°C 10 bar at 60°C	1400151
16 x 2.0	240	6 bar at 90°C 10 bar at 60°C	1400152
16 x 2.0	600	6 bar at 90°C 10 bar at 60°C	1400154
17 x 2.0	120	6 bar at 90°C 10 bar at 60°C	1400251
17 x 2.0	240	6 bar at 90°C 10 bar at 60°C	1400252
17 x 2.0	600	6 bar at 90°C 10 bar at 60°C	1400254
20 x 2.0	240	6 bar at 90°C 8 bar at 70°C	1400352
20 x 2.0	600	6 bar at 90°C 8 bar at 70°C	1400354
26 x 3.0	50	6 bar at 90°C 10 bar at 60°C	1400560
26 x 3.0	200	6 bar at 90°C 10 bar at 60°C	1400562
26 x 3.0	300	6 bar at 90°C 10 bar at 60°C	1400563
32 x 3.0	50	6 bar at 90°C 10 bar at 60°C	1400660



# Copipe HSC Multi-layer composite pipes



**Copipe HSC** multi-layer composite pipes (PE-RT/AL/PE-RT) are suitable for surface heating and cooling. **Copipe** pipes consist of 5 layers (outer jacket pipe made of PE-RT, adhesive lay-

er, longitudinally welded aluminum pipe, adhesive layer and inner medium pipe made of PE-RT). The following dimensions are available: 14 x 2 mm and 16 x 2 mm.

Oxygen tight	Yes	Max. operating pressure (pipe)	6 bar at 90°C 10 bar at 70°C
Material inner layer	Plastic	Number of layers	5
Material intermediate layer	Aluminium	Pipe colour	White
Material outer layer	Plastic		

## PE-RT/AL/PE-RT Copipe HSC Multi-layer composite pipe (manufactured from 2021)



Dimension (mm)	Length of roll (m)	Item No.
14 x 2.0	200	1541420
16 x 2.0	200	1541620
16 x 2.0	500	1541650

# Cofloor Tacker system



The **Cofloor tacker system** consists of base mat rolls or folded boards, pipes and tacker hooks. This system can be used for new construction and renovation. The base mat rolls and the folded boards made of expanded polystyrene are provided with a laminated tissue foil and have an imprinted laying grid (grid distance 5 cm).

Fastening of the Oventrop **Copex** PE-Xc, **Copert** PE-RT plastic pipes or the **Copipe HSC** multi-layer composite pipes (14 mm, 16 mm and 17 mm) is carried out by means

of tacker hooks or alternatively by means of self-adhesive clamping rails made of polypropylene. The base mat rolls and folded boards are laid out on the raw concrete or, if necessary, on the additional insulation.

The **Cofloor tacker system** enables inexpensive, quick and easy laying of the individual components. The clear picture of the laying grid facilitates a straight pipe guidance when fixing the pipe with the handy Oventrop tacker machine. Particularly suitable for standard-compliant concrete screed or liquid screed.

## Base mat roll

10.0 x 1.0 m = 10.0 m<sup>2</sup>



Grid*	50 mm	Impact sound insulation	Yes
Material	EPS	Fire behaviour	RTF-E (according to DIN EN 13501-1)
Pipe diameter*	14 up to 17 mm		

Insulation* (mm)	Impact sound* (dB(A))	Max. load (kN/m <sup>2</sup> )	Stiffness* (MN/m <sup>2</sup> )	Rd* (m <sup>2</sup> K/W)	TCG*	Item No.
20	26	5	30	0.50	040	1402515
35	29	4	15	0.78	045	1402500
30	29	4	15	0.67	045	1402505
25	28	4	20	0.56	045	1402510
30	28	5	20	0.75	040	1402507
20	28	4	20	0.44	045	1402520

## Folded board

2.0 x 1.0 m = 2.0 m<sup>2</sup>



Grid*	50 mm	Impact sound insulation	Yes
Material	EPS	Fire behaviour	RTF-E (according to DIN EN 13501-1)
Pipe diameter*	14 up to 17 mm		

Insulation* (mm)	Impact sound* (dB(A))	Max. load (kN/m <sup>2</sup> )	Stiffness* (MN/m <sup>2</sup> )	Rd* (m <sup>2</sup> K/W)	TCG*	Item No.
35	29	4	15	0.78	045	1402600
30	29	4	15	0.67	045	1402605
30	28	5	20	0.75	040	1402607
25	28	4	20	0.56	045	1402610
20	28	4	20	0.44	045	1402620

### Clamping rail

Laying rail, self-adhesive, clamp distance 5 cm



Description	Item No.
For 14 mm pipe, length 1 m	1402580
For 16 mm pipe, length 1 m	1402581

### Tacker hook

Made of plastic, for 14 - 20 mm pipes



Description	Item No.
Thermowelded, 10 magazines (1 magazine = 30 pieces)	1402594

### Tacker machine

Description	Item No.
For all Oventrop tacker hooks	1402596



# Cofloor Base mat system

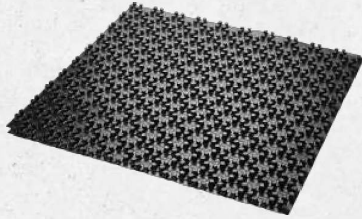

The **Cofloor base mat system** consists of base mats and pipes. This system can be used for new construction and renovation. The base mats have a suitable thermal insulation made of PS (polystyrene) or EPS (expanded polystyrene) in various thicknesses (except for item no. 1402130: only foil), which also serves as impact sound insulation. The special geometry of the nubs (grid dimension 6 cm) allows easy installation of 14 mm, 16 mm and 17 mm **Copex** PE-Xc and **Copert** PE-RT plastic pipes and also **Copipe** HSC multi-layer composite pipes.

The handy base mats know practically no waste. They can be laid economically and in a user-friendly manner in both small, angled and

large-area rooms. The PE foil of the optional edge insulating strips and the overlapping of the base mats at the edge of the board create a dense surface so that cement screed or liquid screed can be applied without further sealing. This reliably prevents a sound bridge to the raw concrete.

There are four different base mats to choose from. The special geometry of the nubs increases the impact resistance of the nubs during pipe installation and ensures that the heating or cooling pipes are held securely in place. The coordinated components enable fast installation even with one-man installation. Particularly suitable for standard-compliant cement or liquid screed.

## Base mat NP

1.44 x 0.84 m = 1.20 m<sup>2</sup>



Rd*	0.00 (m <sup>2</sup> K)/W	Impact sound insulation	No
Grid*	60 mm		

### Material

PS

Pipe diameter\*  
(mm)

14 up to 17

Item No.

1402130

## Base mat NP-11

1.44 x 0.84 m = 1.20 m<sup>2</sup>



Max. load	45 kN/m <sup>2</sup>	Impact sound insulation	Yes
Rd*	0.31 (m <sup>2</sup> K)/W	Fire behaviour	RTF-E (according to DIN EN 13501-1)
Grid*	60 mm		
TCG*	035		

Insulation\*  
(mm)

11

Material

EPS

Pipe diameter\*  
(mm)

14 up to 17

Item No.

1402330

### Base mat NP-30

1.44 x 0.84 m = 1.20 m<sup>2</sup>



Impact sound*	28 dB(A)	TCG*	040
Max. load	5 kN/m <sup>2</sup>	Impact sound insulation	Yes
Rd*	0.75 (m <sup>2</sup> K)/W	Fire behaviour	RTF-E (according to DIN EN 13501-1)
Grid*	60 mm		

Insulation* (mm)	Material	Pipe diameter* (mm)	Item No.
30	EPS	14 up to 17	1402430

### Compensation element 11

1.00 x 1.00 m = 1.00 m<sup>2</sup>



Max. load	60 kN/m <sup>2</sup>	TCG*	035
Rd*	0.31 (m <sup>2</sup> K)/W	Impact sound insulation	No

Insulation* (mm)	Material	Pipe diameter* (mm)	Item No.
11	EPS	14 up to 17	1402390

### Compensation element 30

1.00 x 1.00 m = 1.00 m<sup>2</sup>

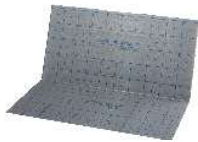

Max. load	5 kN/m <sup>2</sup>	Rd*	0.75 (m <sup>2</sup> K)/W
Stiffness*	20 MN/m <sup>2</sup>		

Insulation* (mm)	Material	Pipe diameter* (mm)	Item No.
30	EPS	14 up to 17	1402490

### Door and distributor/collector element

Can be used in the doorway area and in the area in front of the distributor/collector.



Material	Pipe diameter* (mm)	Item No.
PS	14 up to 17	1402394



**Connecting element**

For laying butt-jointed or butt-to-butt base mats.



Material	Pipe diameter* (mm)	Item No.
PS	14 up to 17	1402393



**Fixing hook**

Made of plastic

Description	Item No.
For base mats, for 14 and 16 mm pipes, bag = 200 pieces	1409082

# Cofloor Thin-layer system

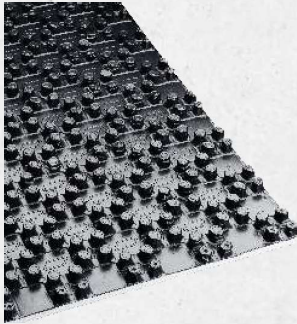

The **Cofloor thin-layer system** consists of a base mat and pipe. This system can be used for new construction and renovation. The base mats have no thermal insulation in order to achieve the lowest possible installation height. The special geometry of the nubs makes it easy to lay 12 mm **Copert PE-RT** plastic pipes.

The handy base mats have practically no waste. They can be laid economically and user-friendly in small, angled rooms as well as in large areas. With the PE foil of the optional edge insulation strips and the overlapping of the base mats at the edge of the mats, a dense surface is obtained so that cement screed or liquid screed can be applied without further

sealing. This reliably prevents a sound bridge to the raw concrete.

The coordinated components allow for a quick installation even with a one-man installation. The suitable levelling compounds should be taken from the data sheet.

Tested minimum construction heights:

- Knauf N 430 min. 17 mm
- PCI periplan extra min. 18 mm
- Weber-Maxit weber.floor min. 18 mm
- Knauf N 440 min. 21 mm
- Mapei Novoplan-Maxi min. 18 mm
- Sopro filler FS 15 plus (FS 15 550) min. 18 mm

More on request.

## Base mat NP-R

1.00 x 1.00 m = 1.00 m<sup>2</sup>



Grid*	50 mm	Impact sound insulation	No
-------	-------	-------------------------	----

### Material

PS

### Pipe diameter\* (mm)

12

### Item No.

1402010

## Edge insulating strip



### Description

With self-adhesive base, height: 50 mm, thickness: 5 mm, roll length: 20 m, only suitable for base mat NP-R

### Item No.

1401990

## PE-RT Copert Plastic pipe



Oxygen tight	Yes	Max. operating pressure (pipe)	6 bar at 70°C
Material inner layer	Plastic	Number of layers	5
Material intermediate layer	Plastic	Pipe colour	White
Material outer layer	Plastic	Quality class	PE-RT II

### Dimension (mm)

12 x 2.0

### Length of roll (m)

200

### Item No.

1401952



**Ofix K Compression fitting**

**Description**

12 x 2.0 mm, 2-fold

**Item No.**

1016870



# Cofloor Velcro system



The **Cofloor Velcro system** consists of a base mat with Velcro velour foil and a Velcro pipe. This system can be used for new construction and renovation. The base mat roll has an imprinted laying grid (grid distance 5 cm).

Fastening of the Oventrop **Copert** PE-RT Velcro plastic pipes or the 16 mm Velcro multi-layer composite pipes is done by simply pressing

the pipe onto the base mat roll. The base mat rolls are laid out on the raw concrete or, if necessary, on the additional insulation.

The **Cofloor system Velcro** enables inexpensive, quick and easy laying of the individual components. The clear picture of the laying grid facilitates straight pipe guidance. Particularly suitable for standard-compliant cement or liquid screed.

## Velcro base mat roll

10.0 x 1.0 m = 10.0 m<sup>2</sup>



Stiffness*	20 MN/m <sup>2</sup>	Pipe diameter*	14 up to 17 mm
Grid*	50 mm	Impact sound insulation	Yes
Material	EPS	Fire behaviour	RTF-E (according to DIN EN 13501-1)
Impact sound*	28 dB(A)		

Insulation* (mm)	Rd* ((m <sup>2</sup> K)/W)	Max. load (kN/m <sup>2</sup> )	TCG*	Item No.
25	0.55	4	045	1403510
30	0.75	5	040	1403507
20	0.44	4	045	1403520

## PE-RT Copert Velcro plastic pipe



Pipe colour	White	Max. operating pressure (pipe)	6 bar at 70°C
Oxygen tight	Yes	Number of layers	5
Material inner layer	Plastic	Quality class	PE-RT II
Material intermediate layer	Plastic	Velcro tape	Yes
Material outer layer	Plastic		

Dimension (mm)	Length of roll (m)	Item No.
16 x 2.0	240	1402162



#### Pipe guiding eye for coil unwinder

Adapter and pipe guiding eye with telescopic extension to be mounted on the coil unwinders item no. 1402096/98. Avoids ground contact of the Velcro pipe during laying.

Description	Item No.
For coil undwinder	1402070

---

#### Pipe guiding eye for walls

For placement e.g. in the area of a door lintel. Avoids ground contact of the Velcro pipe during laying.



Description	Item No.
For Velcro pipe	1402071

# Cofloor Drywall construction system

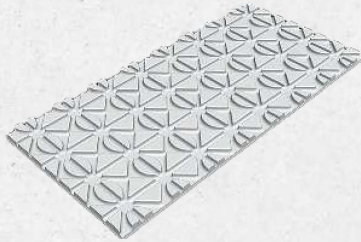

The **Cofloor drywall construction system** consists of drywall construction elements and matching heat/cooling conducting lamellas. The drywall basic element consists of 25 mm thick foamed PS (polystyrene). It is a thermal insulation and at the same time a support element for the individual heat/cooling conducting lamellas and bends. The special arrangement of the grooves in the basic elements allows both a meandering and a bifilar (spiral) installation of the Oventrop **Copipe HSC** multi-layer composite pipe 14 x 2 mm.

We recommend the installation of the **Copipe HSC** multi-layer composite pipe due to its lower expansion coefficient during heating operation compared to the **Copex** PE-Xc and **Copert** PE-RT plastic pipes. The heat/cooling con-

ducting lamellas are made of 0.4 mm thick and the heat/cooling conducting bends of 0.5 mm thick galvanised sheet steel and enable optimum heat/cooling transport into the drywall construction elements or into the cement or liquid screed. The practicable predetermined breaking points on the heat/cooling conducting lamellas (sheet length 998 mm) enable optimal laying of the pipes in the rooms.

The installation of the **Cofloor drywall construction system** is without waste, the execution of the complete installation is possible by only one person. Especially suitable for standard-compliant cement or liquid screed, but also for dry screed elements (e.g. Fermacell panels).

## Drywall construction element

1.0 x 0.5 m = 0.5 m<sup>2</sup>, thickness = 25 mm  
Fire behaviour RTF-E according to DIN EN 13501-1.



### Description

1000 x 500 x 25 mm made of expanded polystyrene, thermal conductivity group 035, laying distance 12.5 cm

### Item No.

1402800

## Heat conducting lamella

998 x 122 mm, sheet metal thickness = 0.4 mm



### Description

Made of galvanised sheet steel

### Item No.

1402850

## Heat conducting bend

245 x 110 mm, sheet metal thickness = 0.5 mm



### Description

For Copipe HSC multi-layer composite pipe 14 x 2 mm, made of galvanised sheet steel

### Item No.

1402855



### Infill panel

1000 x 500 mm, thickness = 25 mm  
Fire behaviour RTF-E according to DIN EN 13501-1.

#### Description

Made of expanded polystyrene, thermal conductivity group 035, load 60 kN/m<sup>2</sup>

#### Item No.

1402857



### Membrane

#### Description

Roll dimensions 25 m x 4 m, made of 0.2 mm polyethylene, for separating the drywall construction system and the screed

#### Item No.

1402895



### Hot cutting machine

#### Description

For cutting individual pipe guides in the infill panel

#### Item No.

1402891

# Cofloor - Accessories and spare parts

## Cofit P Press coupling

Suitable for **Copipe HSC** multi-layer composite pipes and for **Copert** and **Copex** plastic pipes.  
Casing made of stainless steel.



Description	Item No.
14 x 2.0 mm x 14 x 2.0 mm, dezincification resistant brass	1512542
16 x 2.0 mm x 16 x 2.0 mm, bronze	1512543
17 x 2.0 mm x 17 x 2.0 mm, dezincification resistant brass	1512544
20 x 2.5 mm x 20 x 2.5 mm, dezincification resistant brass	1512545
20 x 2.0 mm x 20 x 2.0 mm, dezincification resistant brass	1512541

## Cofit P Press connection coupling

For the transition from copper and stainless steel press systems to **Copipe HSC** multi-layer composite pipes and for **Copert** and **Copex** plastic pipes.  
Not suitable as solder connection.



Description	Item No.
16 x 2.0 mm x 15 mm, bronze	1514043

## Replacement Cofit P Press connection with external thread

Suitable for **Copipe HSC** multi-layer composite pipes and, with the same processing method, also for plastic pipes.  
Casing made of stainless steel.



Description	Item No.
16 x 2.0 mm x R 1/2, bronze	1512043
20 x 2.5 mm x R 1/2, bronze	1512045
26 x 3.0 mm x R 3/4, dezincification resistant brass	1512048
32 x 3.0 mm x R 1, dezincification resistant brass	1512051
40 x 3.5 mm x R 1 1/4, dezincification resistant brass	1512054
50 x 4.5 mm x R 1 1/2, dezincification resistant brass	1512056
63 x 6.0 mm x R 2, dezincification resistant brass	1512057

## Double nipple

G 3/4 conically sealing according to DIN EN 16313 (Eurocone).



Description	Item No.
G 3/4 external thread x G 3/4 external thread, conically sealing, brass, nickel plated	1028263
G 3/4 external thread x G 3/4 external thread, conically sealing, bronze	1504054



**Coil unwinder**

For pipes, for rolls with a length up to 600 m.

**Description**

Stationary  
Mobile with transport chart

**Item No.**

1402096  
1402098



**Bending spring**

**Description**

Bending spring for Copipe, length 600 mm, for 16 x 2.25 mm pipe  
Bending spring for Copipe, length 600 mm, for 20 x 2.5 mm pipe

**Item No.**

1509562  
1509563



**Screed additive**

Additive component for the production of cement screed for heated floor constructions, for homogenisation and improvement of workability, as well as for increasing the bulk density of cement screed.

**Description**

10 kg canister

**Item No.**

1409095



**Edge insulating strip**

**Description**

With self-adhesive base, height: 50 mm, thickness: 5 mm, roll length: 20 m, only suitable for base mat NP-R  
With foil for sealing to the laying system, height: 150 mm, thickness: 10 mm, roll length: 25 m  
With self-adhesive foil for sealing to the laying system, self-adhesive on the wall side, height: 150 mm, thickness: 10 mm, roll length: 25 m

**Item No.**

1401990  
1402090  
1402191



**Expansion joint profile**

**Description**

Made of polyethylene foam, height: 120 mm, thickness: 10 mm, length: 1.20 m

**Item No.**

1402091

### Protective tube

For protecting heating pipes at junctions of screed joints, as well as when entering or leaving the screed.



#### Description

Made of LDPE, 300 mm slotted, for 14, 16 and 17 mm pipes

#### Item No.

1501184

### Pipe guiding elbow

Made of plastic. For redirecting and fixing Copert and Copipe pipes at 90° bends, e.g. in front of the heating circuit distributor/collector and in ceiling openings.



#### Description

For 14, 16 und 17 mm pipes, set = 10 pieces

For 20 mm pipe, set = 10 pieces

For 26 mm pipe, set = 10 pieces

#### Item No.

1409085

1409086

1409087

### Round profile roll

For sealing the transition between the base mat and the edge insulation strip when using cement screed.



#### Description

Made of polyethylene foam, Ø 20 mm, 150 m in a dispenser box

#### Item No.

1402092

### Marker point for measuring screed humidity

For marking locations for measuring the moisture content of the screed.



#### Description

Made of plastic, set = 5 pieces

#### Item No.

1409090

### Tape gun

For masking butt edges on the base mat rolls and insulation boards.



#### Description

For adhesive tape with 50 mm width

#### Item No.

1402598



**Adhesive tape**

For masking butt edges on the base mat rolls and insulation boards against the penetration of screed water.

**Description**

50 mm x 66 m

**Item No.**

1402599



**Replacement press jaw type H**

Suitable for use with Oventrop press machines and with press machines of the following manufacturers: Geberit type PWH75, Klauke types UAP2/UAP/3L/UP2EL, Mannesmann/Novopress types EFP2/ECO1/AFP2/ACO1, Polytherm, Rems, Roller, Rothenberger, Uponor, Velta and Viega type 2

**Description**

Type H 16 A, for 16 mm pipe  
Type H 20 A, for 20 mm pipe  
Type H 26 A, for 26 mm pipe  
Type H 32 A, for 32 mm pipe  
Type H 40 A, for 40 mm pipe

**Item No.**

1519491  
1519492  
1519493  
1519494  
1519495



**Replacement press jaw type RN**

Suitable for use with Oventrop press machines and with press machines of the following manufacturers: Geberit type PWH75, Klauke types UAP2/UAP/3L/UP2EL, Mannesmann/Novopress types EFP2/ECO1/AFP2/ACO1, Polytherm, Rems, Roller, Rothenberger, Uponor, Velta and Viega type 2

**Description**

Type RN 14, for 14 mm pipe  
Type RN 17, for 17 mm pipe  
Type RN 20, for 20 mm pipe

**Item No.**

1519489  
1519488  
1519481



**Replacement Cofit P Press jaw**

Suitable for use with Oventrop press machines and with press machines of the following manufacturers: Klauke types UAP2/UAP/3L and Uponor type UP75

**Description**

For 50 mm pipe  
For 63 mm pipe

**Item No.**

1519445  
1519446





## 1.3 Surface heating and cooling

### **Stations for surface heating systems 179**

Regufloor Control stations for surface heating.....	180
Regufloor - Accessories and spare parts.....	182
Control sets for surface heating.....	184

# Regufloor Control stations for surface heating



The **Regufloor** control stations are used for flow temperature control for surface heating and cooling systems (**Regufloor HC**). In this way, the maximum/minimum permissible flow temperature for surface heating and cooling systems can be maintained. The flow temperature is controlled either by an electronic control in conjunction with an actuator (e.g.

weather-compensated) or by a fixed value control via a temperature controller with contact sensor (only for surface heating). Stations are available as directly operated variants as well as with system separation.

All stations are delivered pre-assembled and tested.

Connection thread heating circuits	G 3/4 external	Max. operating temperature secondary side	50 °C
High-efficiency pump	Yes	Max. operating pressure	6 bar
Max. operating temperature primary side	90 °C	Pump type	

## Regufloor HW

Control station for flow temperature control, with Regtronic RH heating circuit controller, weather-compensated.



Heating circuit controller	Max. heat output (kW)	Pump length (mm)	STL*	Temperature control	Weather-compensated	Item No.
Yes	15	130	Yes	Electronic	Yes	1151800

## Regufloor HN

Control station for flow temperature control, fixed value control.



Heating circuit controller	Max. heat output (kW)	STL*	Temperature control	Weather-compensated	Item No.
No	15	Yes	Thermostatic	No	1151600

## Regufloor HC

Control station for heating / cooling.



Heating circuit controller	Max. heat output (kW)	Pump length (mm)	STL*	Temperature control	Weather-compensated	Item No.
Extendable	15	130	No	Without	No	1152100



**Regufloor HX**

Control station with heat exchanger for system separation.

Heating circuit controller	Pump length (mm)	STL*	Temperature control	Weather-compensated	Item No.
No	130	No	Thermostatic	No	1151065



# Regufloor - Accessories and spare parts



## Aktor M Electromotive actuator 24 V, connection thread M 30 x 1.5

Description	Item No.
0 - 10 V, two point and three point control, 1.5 m cable	1012725
0 - 10 V control, with position feedback, 1.5 m cable	1012726



## Aktor M Electromotive actuator 230 V, connection thread M 30 x 1.5

Description	Item No.
Two point and three point control, 1.5 m cable	1012729



## Aktor T 2P Electrothermal actuator

Description	Item No.
Two point control, "normally closed", 24 V	1012416



## Replacement safety temperature monitor

Description	Item No.
For Wilo pump E15/1-5, with cabling	1151087

### Replacement temperature controller



**Description**

With contact sensor, control range 20 °C - 50 °C

**Item No.**

1151082

### Replacement high-efficiency pump



**Description**

For Regufloor HW/HC/H, Wilo-Yonos PARA RS 15/6, without pump cable

**Item No.**

1151088

### Replacement high-efficiency pump Axial



**Description**

For Regufloor HN, Wilo-Yonos PARA RSB 15/6 with axial pump housing, without pump cable

**Item No.**

1151089

# Control sets for surface heating



The control sets for surface heating are used to control the flow temperature of a surface heating system, e.g. for combined radiator and surface heating systems. The desired flow temperature is set at the temperature controller. The safety temperature monitor switches off the circulation pump as soon as the set value is exceeded due to a malfunction. The bypass valve is used to regulate the volume flow of the surface heating circuit. The control set is available for floor areas up to 85 m<sup>2</sup>, 120 m<sup>2</sup>

and 200 m<sup>2</sup>. Advantages of the control set: all components from only one supplier, uniform warranty, coordinated components, simple installation, flow temperature infinitely adjustable between 20 °C - 50 °C, temperature setting can be limited and blocked as desired and connection possibility to all common surface heating pipes. The control set consists of a straight valve, a bypass valve, a temperature controller with contact sensor and a safety temperature monitor.

## Set 1 for surfaces up to 85 m<sup>2</sup>



### Consisting of

- Item no. 1180104 (M 30 x 1.5)  
Thermostatic valve DN 15, brass, nickel plated, straight version
- Item no. 1027666  
Bypass valve DN 20, brass, nickel plated, straight version
- Item no. 1142861 (M 30 x 1.5)  
Temperature controller with contact sensor and heat conducting base, capillary tube length 2 m, control range 20 °C - 50 °C
- Item no. 1143000  
Safety temperature monitor with concealed temperature setting, control range 20 °C - 90 °C

### Item No.

1144251

## Set 2 for surfaces up to 120 m<sup>2</sup>



### Consisting of

- Item no. 1187106 (M 30 x 1.5)  
Thermostatic valve DN 20, brass, nickel plated, straight version
- Item no. 1027668  
Bypass valve DN 25, brass, nickel plated, straight version
- Item no. 1142861 (M 30 x 1.5)  
Temperature controller with contact sensor and heat conducting base, capillary 2 m, control range 20 °C - 50 °C
- Item no. 1143000  
Safety temperature monitor with concealed temperature setting, control range 20 °C - 90 °C

### Item No.

1144252

## Set 3 for surfaces up to 200 m<sup>2</sup>



### Consisting of

- Item no. 1131206 (M 30 x 1.5)  
Tri CTR Three-way diverting and mixing valve DN 20, bronze
- Item no. 1142861 (M 30 x 1.5)  
Temperature controller with contact sensor and heat conducting base, capillary 2 m, control range 20 °C - 50 °C
- Item no. 1072006  
Check valve DN 20, bronze, brass
- Item no. 1143000  
Safety temperature monitor with concealed temperature setting, control range 20 °C - 90 °C

### Item No.

1144253



## 1.3 Surface heating and cooling

<b>Room thermostats</b>	<b>185</b>
ClimaCon F Room thermostats for surface heating...	186
Room thermostats heating, flush mounting.....	189
Room thermostats heating/cooling.....	190
Connecting blocks.....	191
Actuators.....	193
Actuators - Accessories.....	194
wibutler Smart Home system.....	195
R-Tronic System for individual room temperature control.....	198
R-Tronic - Accessories.....	202

# ClimaCon F Room thermostats for surface heating



The ClimaCon F room thermostats are used for temperature control of surface heating and cooling systems as well as heating and cooling ceilings in detached houses or dwellings. Depending on the room thermostat, switching between heating and cooling is possible via a change-over signal, e.g. from the heat pump. The ClimaCon F room thermostats can be used in combination with electrothermal ac-

tuators (e.g. Aktor T 2P). Alternatively, connection to a connecting block (e.g. FloorCon) is possible. The simple surface-mounted installation and quick configuration make the product very installer-friendly.

Depending on the model, there are room thermostats with reduced display, with integrated time switch and setting options via app.

## ClimaCon F 100 for two pipe applications, heating or cooling, follower



Control	Two point / PWM	Operation	At the room thermostat
Installation	Surface mounting	Switching h / c*	Via change-over
Setback*	Via leader room thermostat		

Tension	Suitable for	Item No.
230 V AC	Electrothermal actuators (two point) "normally closed"	1155010
24 V AC	Electrothermal actuators (two point) "normally closed"	1155510

## ClimaCon F 310 for two pipe applications, heating or cooling, leader

Switching between time programme and manual mode possible.



Control	Two point / PWM	Switching h / c*	Via change-over
Installation	Surface mounting	Other outputs	1 x potential-free
Setback*	Via time programme (adjustable in the app) Via Eco button at the room thermostat	Communication	Bluetooth
Operation	At the room thermostat With smartphone app		

Tension	0 - 10 V*	Temperature sensor*	Suitable for	Item No.
230 V AC	No	No	Electrothermal actuators (two point) "normally closed"	1155031
24 V AC	Yes	Yes	Electrothermal actuators (two point) "normally closed" Electrothermal actuators (0 - 10 V) "normally closed"	1155531





**ClimaCon F 90 for two pipe applications, heating only/cooling only, follower**

Control	PWM	Setback*	Via leader room thermostat
Installation	Surface mounting	Operation	At the room thermostat

Tension	Suitable for	Item No.
230 V AC	Electrothermal actuators "normally closed" (heating) Electrothermal actuators "normally open" (cooling)	1155009



**ClimaCon F 210 for two pipe applications, heating only/cooling only, leader**

Switching between time programme and manual mode possible.

Control	Two point / PWM	Operation	At the room thermostat
Installation	Surface mounting		With smartphone app
Setback*	Via time programme (adjustable in the app) Via Eco button at the room thermostat	Communication	Bluetooth

Tension	Suitable for	Item No.
230 V AC	Electrothermal actuators (two point) "normally closed"	1155021



ClimaCon F 90

ClimaCon F 100

ClimaCon F 210

ClimaCon F 310



	230 V	230 V	24 V	230 V	230 V	24 V
Item no.	1155009	1155010	1155510	1155021	1155031	1155531

**Application**

Heating only / Cooling only	●	—	—	●	—	—
Heating or cooling (switchable)	—	●	●	—	●	●

**Display**

Setpoint temperature	●	●	●	●	●	●
Actual temperature	—	—	—	●	●	●
Status (heating / cooling)	—	—	—	●	●	●
Mode (Auto / Eco)	—	—	—	●	●	●

**Setting options**

Temperature setting at the room thermostat	●	●	●	●	●	●
Temperature setting via time profiles in the app	—	—	—	●	●	●
Setback activation at the room thermostat	—	—	—	●	●	●
Timed setback via app	●*	●*	●*	●	●	●
Setback temperature	4 K	4 K	4 K	Flexible via app	Flexible via app	Flexible via app
Temperature limitation via app	—	—	—	●	●	●
External limiter function – automatic switch-off when reaching the max. / min. temperature set via app	—	—	—	—	—	●

\* Leader function - only possible if leader room thermostats (ClimaCon F 210 / F 310) or a FloorCon connecting block are used.

# Room thermostats heating, flush mounting



The flush-mounted electric room thermostat is required in conjunction with the Aktor T 2P electrothermal actuators (two point) for individual room temperature control.

Heating: Use electrothermal actuators (two

point) "normally closed". Temperature setback possible via external time switch.

Cooling: Use electrothermal actuators (two point) "normally open".



## Room thermostat for two pipe applications, flush mounting

Setpoint range can be limited by concealed locking clips.

Control Two point Setback\* Via external time switch (follower function)

Tension	Suitable for	Item No.
230 V AC	Electrothermal actuators "normally closed" (heating) Electrothermal actuators "normally open" (cooling)	1152071

# Room thermostats heating/cooling



Room thermostats are used in conjunction with electromotive or electrothermal actuators for individual room temperature control in heating and cooling systems. This room thermostat

can also be used in three or four pipe systems and has an adjustable neutral zone between heating and cooling stage. The temperature is set at the room thermostat.

### Room thermostat for four pipe applications, surface mounting

Neutral zone      Adjustable between 0.5 K and 7.5 K



Tension	Control	Suitable for	Item No.
24 V AC	0 - 10 V (2x)	Electrothermal actuators (0 - 10 V) "normally closed"	1152151 °

# Connecting blocks



The connecting block is used for wiring individual room controls and is used for surface heating and cooling control. With the connecting block, a simple assignment of the individual rooms or heating circuits can be carried out centrally. Depending on the variant, up to 10

zones for heating and cooling systems with up to 18 actuators and 10 room thermostats can be connected to the connecting block. In addition, further components, such as a pump, a change-over signal transmitter, a temperature limiter or dew point sensor can be wired.

## Electrical connecting block for surface heating

When using item no. 1400980 / 82 with 24 V, an external power supply of 24 V must be available. Item no. 1153053 can be used as transformer.



### Description

Description	Item No.
6 control zones, heating, 24 V / 230 V	1400980
10 control zones, heating / cooling (change-over), pump control, 230 V	1400981
10 control zones, heating / cooling (change-over), pump control, 24 V	1400982
10 control zones, heating / cooling (change-over), pump and boiler control and integrated time switch, 230 V	1400983

## FloorCon Electrical connecting block with automatic hydronic balancing for surface heating and cooling



### Description

Description	Item No.
FloorCon F 200, without channel allocation, connection of 8 room thermostats / 12 actuators, 230 V	1400984 ::
FloorCon F 300, with channel allocation, connection of 8 room thermostats / 12 actuators, 230 V	1400985 ::

## Temperature sensor for FloorCon

The temperature sensor is required 1x for the supply of the heating circuit distributor/collector and 1x in the return per heating circuit.



### Description

Description	Item No.
Temperature sensor for FloorCon F, 850 mm	1029094 ::



### Aktor T 2P electrothermal actuator for FloorCon connecting block

**Description**

Two point control, "normally closed", 230 V, 2 m cable

**Item No.**

1012452

---

### Safety temperature limiter



**Description**

For max. limitation of the heating circuit temperature, 20 °C - 90 °C

**Item No.**

1344583

---

### Sensor GA FD Dew point monitor

Is required in conjunction with room thermostats to protect against condensation on cooling surfaces.



**Description**

For heating/cooling applications to prevent condensation, 24 V, with change-over contact

**Item No.**

1141951

# Actuators



Electrothermal and electromotive actuators are used for heating, ventilation and air conditioning. The actuators can be used for room temperature control or as zone valves. Oventrop offers actuators in the variants "normally closed" and "normally open".

All electrothermal actuators are protected against overvoltage, a varistor is not required.

Oventrop offers electromotive actuators with and without communication interfaces.



## Aktor T 2P two point control

Valve connection	Connection thread M 30 x 1.5	Stroke	5 mm
Installation position	Any		
Installation	Plug-in connection with valve adapter		

Tension	Version	Cable* (m)	Item No.
230 V AC	"Normally closed"	1	1012415
24 V AC / DC	"Normally closed"	1	1012416
230 V AC	"Normally open"	1	1012425
24 V AC / DC	"Normally open"	1	1012426
230 V AC	"Normally closed" with integrated auxiliary switch	1	1012435
24 V AC / DC	"Normally closed"	2	1012442
230 V AC	"Normally closed"	5	1012455
230 V AC	"Normally closed"	10	1012459



## Aktor T ST 0 - 10 V control

Valve connection	Connection thread M 30 x 1.5	Installation	Plug-in connection with valve adapter
Zero point detection	Yes		
Valve travel detection	Yes	Stroke	5 mm
Installation position	Any		

Tension	Version	Cable* (m)	Item No.
24 V AC	"Normally closed"	1	1012953



# Actuators - Accessories



## Valve adapter

### Description

For valves with squeeze connection

### Item No.

1012463



# wibutler Smart Home system



The Smart Home sector includes the networking of several trades within individual dwellings or detached houses. By means of a gateway, various components can be integrated into the Smart Home system and controlled via smartphone, tablet or PC. By connecting the gateway to a commercially available rout-

er, remote access is easily possible while on the move.

The intelligent wibutler pro 2 gateway is the heart of the smart home. In addition to surface heating and radiators, other systems such as lighting and shading can also be integrated.

## Basic set - surface heating 2



### Scope of delivery

- 1 x R-Tronic RT B wireless thermostat item no. 1150780
- 1 x R-Con eight-channel wireless receiver item no. 1150772

### Item No.

1150793



## Basic set - surface heating



### Scope of delivery

- 1 x wibutler per item no. 1150799
- 1 x R-Tronic RT B wireless thermostat item no. 1150780
- 1 x R-Con eight-channel wireless receiver item no. 1150772

### Item No.

1150795 °



## wibutler gateway 2 (EnOcean, Zigbee, LAN, WLAN)



Operation

- With smartphone app
- With tablet app
- Via computer
- Amazon Alexa

System requirements terminals

Apple: at least iOS 9

### Tension

### Item No.

1150791



**wibutler gateway (EnOcean, Z-Wave, Zigbee, LAN, WLAN)**

The lighting, shading, heating and sanitary, air conditioning, ventilation and security systems can be interconnected with the help of the wibutler gateway.

Operation	With smartphone app With tablet app Via computer Amazon Alexa	System requirements terminals	Apple: at least iOS 9 Android: at least Android 4.4
-----------	--	-------------------------------	--

<b>Tension</b>	<b>Item No.</b>
100 - 240 V AC	1150799 °

**R-Tronic Wireless thermostat (EnOcean)**



Installation	Surface mounting	Power supply	Battery operated
Communication	EnOcean		

Designation	Humidity sensor*	EEP*	Item No.
RT B (EnOcean)	No	A5-10-02	1150780
		A5-10-03	
		A5-10-04	
		A5-10-06	
		A5-10-06 + RPS	
RTF B (EnOcean)	Yes	A5-10-11	1150781
		A5-10-12	
		A5-10-22	
		A5-10-23	

**R-Con Multi-channel wireless receiver for surface heating (proprietary radio communication)**

Time programme adjustable with R-Tronic wireless thermostats. Item no. 1150770 / 72 additionally with pump and burner logic. To be installed in a cabinet, the protective housing item no. 1150776 (see "R-Con Accessories") can be used alternatively.



Tension	230 V AC	Communication	Proprietary radio
Control	Two point / PWM	Installation	Carrier rail (DIN EN 60715 TH35)

Number of radio channels	Logic module	Item No.
4 (max. of 4 actuators per channel)	Yes	1150770
4 (max. of 4 actuators per channel)	No	1150771
8 (max. of 4 actuators per channel)	Yes	1150772
8 (max. of 4 actuators per channel)	No	1150773

**R-Con T 2P Four-channel extension module (proprietary radio communication)**

For R-Con multi-channel wireless receiver.



Tension	230 V AC	Communication	Proprietary radio
Control	Two point / PWM	Installation	Carrier rail (DIN EN 60715 TH35)

Number of radio channels	Item No.
4 (max. of 4 actuators per channel)	1150775



**R-Con HC Extension module heating/cooling (proprietary radio communication)**

For R-Con multi-channel radio receiver. For switching between heating and cooling mode via a change-over input. The change-over signal is provided e.g. by a reversible heat pump.

Tension	230 V AC	Installation	Carrier rail (DIN EN 60715 TH35)
Communication	Proprietary radio		



Inputs	Item No.
Dew point monitoring, cooling mode is interrupted if the dew point is exceeded	1150774



**mote 420 Wireless actuator (EnOcean)**

Only functions in combination with communication centres / gateways (e.g. with the wibutler gateway) and room thermostats supporting this EnOcean Equipment Profile.

Communication	EnOcean	Battery lifespan	About 2 years
Power supply	Battery operated		



Valve connection	EEP*	Item No.
Connection thread M 30 x 1.5	A5-20-01	1150766



**FK-C F Wireless window contact (EnOcean)**

With EnOcean radio technology. Transmits a radio signal when opening or closing a window. Compatible with R-Tronic wireless thermostats (mains operated), wireless room module (DynaTemp CR-BSX) and wibutler gateway.

Power supply	EEP*	Colour	Item No.
Solar powered	D5-00-01	White	1153070



# R-Tronic System for individual room temperature control



The R-Tronic wireless thermostats with closed radio communication (proprietary) are used in stand-alone operation in connection with wireless actuators to control radiators or in connection with a multi-channel wireless receiver to control surface heating systems.

The temperature setting as well as the storage of time programmes is carried out at the wireless thermostat. Depending on the model, an additional measurement of the relative humidity in % and the CO<sub>2</sub> concentration in ppm is possible.

Power is supplied by batteries or a power supply unit (100 - 240 V). For the battery-operated models, power supply via the mains is possible as an alternative.

In battery operation, up to 3 participants can be taught in, in mains operation, up to 8 participants can be taught in. In mains operation it is also possible to teach in wireless actuators, window contacts and a single-channel wireless receiver. The single-channel wireless receiver enables the control of a fan depending on the set CO<sub>2</sub> threshold value. For this application a thermostat must be used which can measure the CO<sub>2</sub> concentration.



## R-Tronic Wireless thermostat (proprietary radio communication)



Installation Surface mounting Communication Proprietary radio

Designation	Humidity sensor*	CO <sub>2</sub> sensor	Power supply	Item No.
RT B	No	No	Battery operated	1150680
RTF B	Yes	No	Battery operated	1150681
RTFC K	Yes	Yes	Plug-in power supply unit with table stand	1150682 °
RTFC K	Yes	Yes	Flush-mounted power supply unit with wall bracket	1150684 °

## note 320 Wireless actuator (proprietary radio communication)



Power supply Battery operated Communication Proprietary radio  
Battery lifespan About 2 years

Valve connection	Note	Item No.
Connection thread M 30 x 1.5	-	1150665
Squeeze connection	For integrated valve sets and thermostatic valves of the company Danfoss, series RA	1150675 °

### R-Con Multi-channel wireless receiver for surface heating (proprietary radio communication)

Time programme adjustable with R-Tronic wireless thermostats. Item no. 1150770 / 72 additionally with pump and burner logic. To be installed in a cabinet, the protective housing item no. 1150776 (see "R-Con Accessories") can be used alternatively.



Tension	230 V AC	Communication	Proprietary radio
Control	Two point / PWM	Installation	Carrier rail (DIN EN 60715 TH35)



Number of radio channels	Logic module	Item No.
4 (max. of 4 actuators per channel)	Yes	1150770
4 (max. of 4 actuators per channel)	No	1150771
8 (max. of 4 actuators per channel)	Yes	1150772
8 (max. of 4 actuators per channel)	No	1150773



### R-Con T 2P Four-channel extension module (proprietary radio communication)

For R-Con multi-channel wireless receiver.

Tension	230 V AC	Communication	Proprietary radio
Control	Two point / PWM	Installation	Carrier rail (DIN EN 60715 TH35)



Number of radio channels	Item No.
4 (max. of 4 actuators per channel)	1150775



### R-Con HC Extension module heating/cooling (proprietary radio communication)

For R-Con multi-channel radio receiver. For switching between heating and cooling mode via a change-over input. The change-over signal is provided e.g. by a reversible heat pump.

Tension	230 V AC	Installation	Carrier rail (DIN EN 60715 TH35)
Communication	Proprietary radio		



Inputs	Item No.
Dew point monitoring, cooling mode is interrupted if the dew point is exceeded	1150774



### Aktor T 2P Electrothermal actuator, two point control

Installation position	Any
Installation	Plug-in connection with valve adapter

Tension	Version	Valve connection	Cable* (m)	Item No.
230 V AC	"Normally closed"	Connection thread M 30 x 1.5	1	1012415
24 V AC / DC	"Normally closed"	Connection thread M 30 x 1.5	1	1012416



**R-Con 2P Wireless receiver for fan control (proprietary radio communication)**

For activation and deactivation of fans or ventilation systems. The switching signal is generated by the wireless thermostat. Compatible with R-Tronic RTFC K wireless thermostat item no. 1150682 / 84.

Tension	230 V AC	Communication	Proprietary radio
Installation	Flush mounting		

**Number of radio channels**

1 x potential-free

**Item No.**

1150710 °

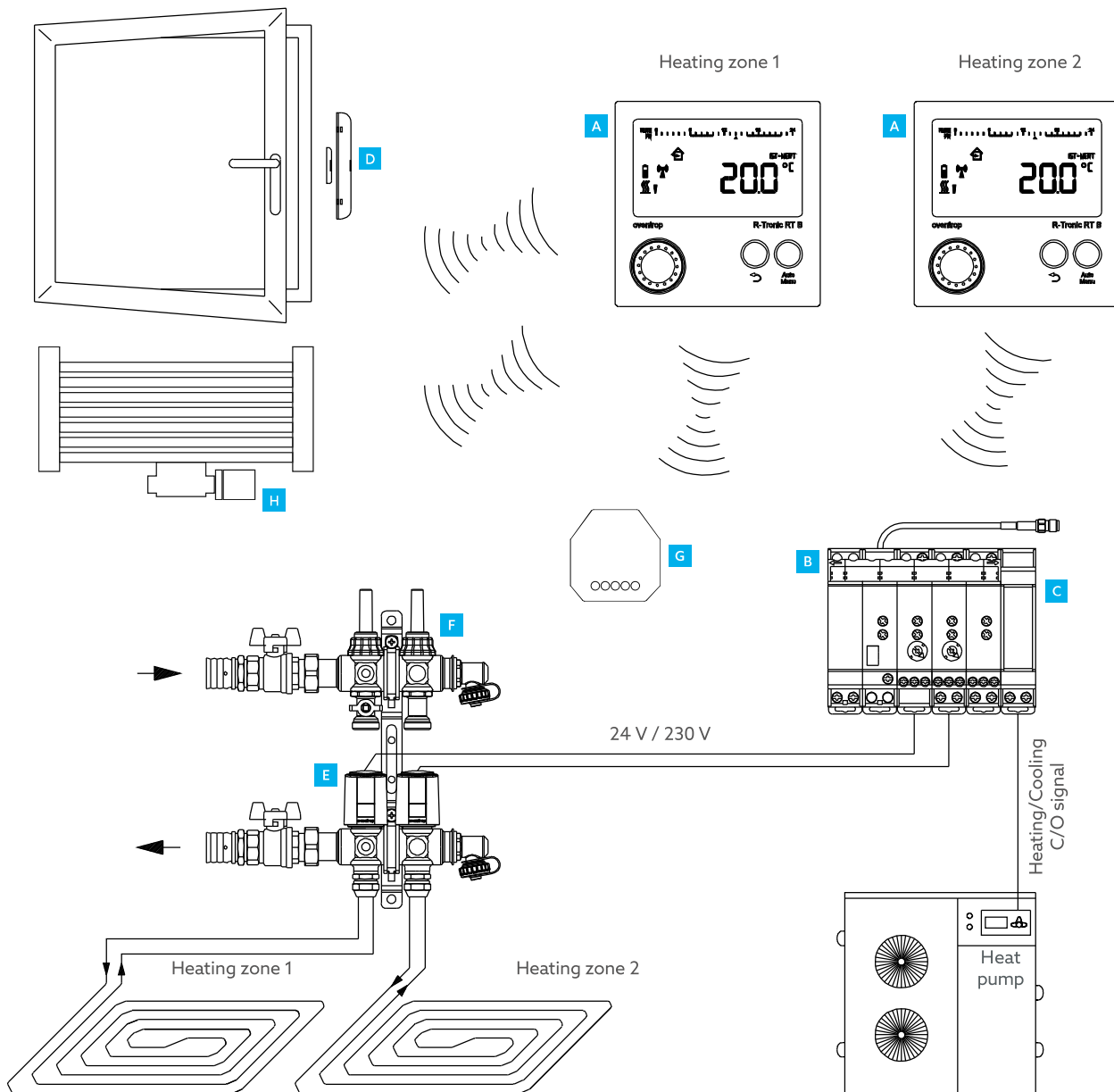

<b>A</b>	<b>R-Tronic RT B / R-Tronic RTF B</b> Wireless thermostat	1150680/81
<b>B</b>	<b>R-Con</b> Wireless receiver	1150770-73
<b>C</b>	<b>R-Con HC</b> Extension module heating / cooling	1150774
<b>D</b>	<b>FK-C F</b> Wireless window contact	1153070

<b>E</b>	<b>Aktor T 2P</b> Electrothermal actuator two point control	1012415/16
<b>F</b>	<b>Multidis SF</b> Heating circuit distributor/collector	1406552-62 1404952-62
<b>G</b>	Wireless repeater	1153060
<b>H</b>	<b>mote 320</b> Wireless actuator	1150665/75

# R-Tronic - Accessories

## Flush-mounted power supply unit with wall bracket



### Description

For the conversion of battery operated R-Tronic wireless thermostats to an external power supply 100 - 240 V AC, 50 - 60 Hz

### Item No.

1150692

## Plug-in power supply unit with table stand



### Description

For the conversion of battery operated R-Tronic wireless thermostats to an external power supply 100 - 240 V AC, 50 - 60 Hz

### Item No.

1150694

## Cover frame



### Description

For covering flush-mounted box ( milled hole up to Ø 83 mm, e.g. Switzerland), cover 88 x 88 mm, traffic white (RAL 9016)

### Item No.

1150693

## Wireless repeater (EnOcean)



### Description

For amplification of EnOcean radio telegrams to increase the radio range, 230 V AC, 50 Hz, flush mounting

### Item No.

1153060





### Protective housing with carrier rail



#### Description

As alternative to installation in the cabinet, 230 V, surface mounting

#### Item No.

1150776

### Antenna extension



#### Description

With SMA screw terminal, antenna length 1 m, surface mounting, white glossy (RAL 9003)

#### Item No.

1150777



## 1.3 Surface heating and cooling

### **Surface temperature regulation with 204 return temperature limitation**

Unibox Return temperature control.....	206
Unibox Room temperature control and return temperature control.....	208
Unibox - Accessories and spare parts.....	210



High-quality  
design  
in genuine glass



# Feel-good guarantee in the bathroom? **Stylish room temperature control.**

*You will love this comfort:* a room temperature regulated according to your wishes. *Your highlight:* Our new **Unibox** with a genuine glass cover, crafted in a high-quality design and available in different colours and styles.  
**Wir regeln das. Seit 1851.**

Find out more about the Unibox and our modular solutions for room temperature control now at:

[unibox.oventrop.com](http://unibox.oventrop.com)



**oventrop**

Wir regeln das. Seit 1851.

# Unibox Return temperature control



The **Unibox** return temperature control is used for surface temperature regulation of rooms with a size of up to 20 m<sup>2</sup>, such as the bathroom. The Uniboxes are particularly suitable for retrofitting a surface temperature regulation in heating systems in combined use with radiators. The **Unibox** consists of a wall mounting box with thermostatic valve, an integrated return temperature limiter, a vent

and flush valve and a cover with integrated handwheel. The cover of the Unibox E RTL is closed. The setpoint range is adjustable between 10 °C and 50 °C for the **Unibox RTL** and between 20 °C and 40 °C for the **Unibox E-RTL**. The cover with the integrated handwheel enables angle and depth compensation of the flush-mounted box installed in the wall.

Return temperature control	Yes	Pipe connection	G ¾
Cover	Yes	Venting	Yes
Room temperature control	No	Presetting	No

## Unibox RTL plastic white



Operation	Cover*	Cover colour	Operating element colour	Item No.
Handwheel	Plastic	White	White	1022735

## Unibox RTL genuine glass white



Operation	Cover*	Cover colour	Operating element colour	Item No.
Handwheel	Genuine glass	White	Chrome	1022750

## Unibox RTL genuine glass black



Operation	Cover*	Cover colour	Operating element colour	Item No.
Handwheel	Genuine glass	Black	Dark chrome	1022751

**Unibox E RTL**



<b>Operation</b>	<b>Cover*</b>	<b>Cover colour</b>	<b>Item No.</b>
Internal	Plastic	White	1022731
Internal	Genuine glass	White	1022760
Internal	Genuine glass	Black	1022761





# Unibox Room temperature control and return temperature control



The **Unibox** room and return temperature control is used for surface temperature regulation of rooms with a size of up to 20 m<sup>2</sup>, such as the bathroom. The Uniboxes are particularly suitable for retrofitting a surface temperature regulation in heating systems in combined use with radiators. The **Unibox** is also used for individual room temperature control. The **Unibox** consists of a wall mounting box with presettable thermostatic valve, an integrated

return temperature limiter, a vent and flush valve, a valve insulation and a cover with integrated thermostat. The cover of the Unibox T-RTL R-Tronic and TQ-RTL R-Tronic is closed. The setpoint range is adjustable between 20 °C and 40 °C (return temperature) and between 7 °C and 28 °C (room temperature). The cover with the integrated thermostat enables angle and depth compensation of the flush-mounted box installed in the wall.

Return temperature control	Yes	Venting	Yes
Room temperature control	Yes	Presetting	Yes
Pipe connection	G 3/4		



2021



2019

## Unibox T-RTL plastic white



Cover	Operation	Cover*	Cover colour	Operating element colour	Q-Tech	Item No.
Yes	Thermostat	Plastic	White	White	No	1022733

## Unibox T-RTL genuine glass white



Cover	Operation	Cover*	Cover colour	Operating element colour	Q-Tech	Item No.
Yes	Thermostat	Genuine glass	White	Chrome	No	1022770

## Unibox T-RTL genuine glass black



Cover	Operation	Cover*	Cover colour	Operating element colour	Q-Tech	Item No.
Yes	Thermostat	Genuine glass	Black	Dark chrome	No	1022771

### Unibox T-RTL R-Tronic

Suitable for radio control with an R-Tronic wireless thermostat (not compatible with wibutler).



Cover	Operation	Cover*	Cover colour	Item No.
Yes	Radio	Plastic	White	1022737
Yes	Radio	Genuine glass	White	1022772

### Unibox T-RTL vario (basic model)

Cover must be ordered separately (accessory).



Cover	Operation	Item No.
No	Internal	1022734

### Unibox TQ-RTL



Cover	Operation	Cover*	Cover colour	Operating element colour	Q-Tech	Item No.
Yes	Thermostat	Plastic	White	White	Yes	1022739
Yes	Thermostat	Genuine glass	White	Chrome	Yes	1022780
Yes	Thermostat	Genuine glass	Black	Dark chrome	Yes	1022781

### Unibox TQ-RTL R-Tronic

Suitable for radio control with an R-Tronic wireless thermostat (not compatible with wibutler).



Cover	Operation	Cover*	Cover colour	Q-Tech	Item No.
Yes	Radio	Plastic	White	Yes	1022738
Yes	Radio	Genuine glass	White	Yes	1022782

### Unibox TQ-RTL vario (basic model)

Cover must be ordered separately (accessory).



Cover	Operation	Q-Tech	Item No.
No	Internal	Yes	1022736

# Unibox - Accessories and spare parts

## R-Tronic R-TB Wireless thermostat (EnOcean) for Unibox T-RTL R-Tronic and Unibox TQ-RTL R-Tronic

In conjunction with the Unibox not compatible with wibutler.



**Description**

For the connection to Smart Home gateways (e.g. wibutler), with EnOcean radio technology, surface mounting, battery operated

For the connection to Smart Home gateways (e.g. wibutler), with EnOcean radio technology, surface mounting, battery operated, with humidity sensor

**Item No.**

1150780

1150781



## ClimaCon F 90 Room thermostat (heating only/cooling only)

For Unibox T vario, TQ vario, T-RTL vario, TQ-RTL vario and E BV vario.



**Tension**

**Control**

**Suitable for**

**Item No.**

230 V AC

PWM

Electrothermal actuators "normally closed" (heating)  
 Electrothermal actuators "normally open" (cooling)

1155009

## ClimaCon F 210 Room thermostat (heating only/cooling only)

For Unibox T vario, TQ vario, T-RTL vario, TQ-RTL vario and E BV vario.



**Tension**

**Control**

**Suitable for**

**Item No.**

230 V AC

Two point / PWM

Electrothermal actuators (two point) "normally closed"

1155021

## Aktor T 2P Electrothermal actuator

For Unibox T vario, TQ vario, T-RTL vario, TQ-RTL vario and E BV vario.



**Description**

Two point control, "normally closed", 230 V

Two point control, "normally closed", 230 V, 2 m cable

**Item No.**

1012415

1012452



### Uni FHU Thermostat with remote control



Description	Item No.
White, 2 m capillary tube	1012595
White, 5 m capillary tube	1012596
White, 10 m capillary tube	1012597

### Cover



Description	Item No.
White, for Unibox T-RTL vario, TQ-RTL vario, T vario, TQ vario and E BV vario, closed	1022776
Genuine glass white, for Unibox T-RTL vario, TQ-RTL vario, T vario, TQ vario and E BV vario, closed	1022774
Genuine glass black, for Unibox T-RTL vario, TQ-RTL vario, T vario, TQ vario and E BV vario, closed	1022775

### Duo connection piece



Description	Item No.
For the connection of two heating circuits, 1 x G 3/4 union nut, 2 x G 3/4 external thread	1022655

### Extension



Description	Item No.
For thermostatic valves and Uniboxes (manufactured until 2019), 20 mm	1022698

### Extension



Description	Item No.
For Unibox RTL, for RTLH valves, 20 mm	1022699

### Valve insert



Description	Item No.
For reversed supply and return pipe, for Unibox and RTL valves	1026970
For Unibox and RTLH valves, M 30 x 1.5	1026981
For AV 9, CV 9, RFV 9, and E thermostatic valves, Multiblock T-RTL and Unibox, M 30 x 1.5, DN 10 - DN 20, kv = 0.67	1187047
For AQ, RFQ and EQ thermostatic valves, Multiblock TQ and TQ-RTL, Multiflex FQ as well as Unibox TQ and TQ vario, 10 - 170 l/h, M 30 x 1.5	1187065
For reversed supply and return pipe, for A, AV 9, ADV 9, CV 9, E, AF, RF and RFV 9 thermostatic valves, Multiblock T, TU and TFU as well as Unibox, M 30 x 1.5, with presetting	1187078



**Press connection coupling**

For the transition from copper and stainless steel press systems to Copipe multi-layer composite pipes. Not suitable as solder connection.



Description	Item No.
16 x 2.0 mm x 15 mm, bronze	1514043

**Replacement thermostat for Unibox RTL**



Description	Item No.
For Unibox RTL	1027635

**Replacement cover for Unibox E RTL and Unibox RLA vario**



Description	Item No.
Plastic white	1022766
Genuine glass white	1022764
Genuine glass black	1022765

**Replacement cover for Unibox RTL**

With integrated handwheel.



Description	Item No.
Plastic white	1022789
Genuine glass white	1022787
Genuine glass black	1022788

**Replacement cover for Unibox T, T-RTL, TQ-RTL and E BV**

With integrated thermostat.



Description	Item No.
Plastic white	1022779
Genuine glass white	1022777
Genuine glass black	1022778



**Replacement cover for Unibox (manufactured until 2019)**

**Description**

- For Unibox RTL, T, vario and plus, plastic, white, depth 57 mm
- For Unibox RTL, T, vario and plus, plastic, chrome plated, depth 57 mm

**Item No.**

- 1022693
- 1022694



**Replacement cover for Unibox (manufactured until 2000)**

**Description**

- For Unibox RTL, T and plus, plastic, white, depth 110 mm

**Item No.**

- 1022691



**Replacement valve insulation for Uniboxes with thermostatic control**

**Description**

- For Unibox T, T-RTL, E BV and T-RTL vario
- For Unibox TQ, TQ-RTL and TQ-RTL vario

**Item No.**

- 1022792
- 1022794



## 1.3 Surface heating and cooling

### **Surface heating with decentralised distribution** 214

---

Unidis Connection without distributor/collector for surface heating.....	215
Unidis - Accessories and spare parts.....	218

# Unidis Connection without distributor/collector for surface heating



**Unidis** is a surface heating system with decentralised distribution. The supply and return pipes are laid directly on the bare floor, so that no distributor/collector is required. Surface heating systems have long been standard in new housing construction. They offer a high level of comfort and increased living quality. At the same time, surface heating systems save energy and costs. An essential component of the **Unidis** surface heating system is the **Unibox E BV** featuring a patented integrated bypass that can be individually adjusted for each

room.

Advantages of the system are:

- no laying bottlenecks due to the supply pipes from the central distributor to the individual rooms
- no uncontrolled heat dissipation due to supply and return pipes
- hallways larger than 6 m<sup>2</sup> have their own thermostatically controlled heating circuit
- increased sound insulation
- savings potential of up to 9% in combination with the **Unibox E BV**

## Floorbox UH horizontal riser connection



### Consisting of

- Supply:
- Ball valve G 1 with temperature sensor connection
- Return:
- Hycocon VTZ Double regulating and commissioning valve
  - Meter spacer
  - Ball valve with coupling
  - Vent / flush valve
  - Flat seals

### Item No.

1022668

## Floorbox UV vertical riser connection



### Consisting of

- Supply:
- Ball valve G 1 with temperature sensor connection
- Return:
- Hycocon VTZ Double regulating and commissioning valve
  - Meter spacer
  - Ball valve with coupling
  - Vent / flush valve
  - Flat seals

### Item No.

1022669

## Unibox E BV Room temperature control with bypass



Presetting	Yes	Return temperature control	No
Cover	Yes	Venting	Yes
Room temperature control	Yes		

Operation	Cover*	Cover colour	Operating element colour	Item No.
Thermostat	Plastic	White	White	1022724



**Unibox E BV vario (basic model) Room temperature control with bypass**

Presetting	Yes	Return temperature control	No
Cover	No	Venting	Yes
Room temperature control	Yes		

Operation	Item No.
Without	1022725



**Unibox RLA vario (basic model) Flush-mounted box for return shutoff**

Presetting	Yes	Venting	Yes
Cover	No		

Operation	Item No.
Without	1022726



**Unibox T Room temperature control**

Pipe connection	G 3/4	Room temperature control	Yes
Presetting	Yes	Return temperature control	No
Cover	Yes	Venting	Yes

Operation	Cover*	Cover colour	Operating element colour	Item No.
Thermostat	Plastic	White	White	1022722



**Unibox T vario (basic model) Room temperature control**

Pipe connection	G 3/4	Room temperature control	Yes
Presetting	Yes	Return temperature control	No
Cover	No	Venting	Yes

Operation	Item No.
Without	1022723



**Unibox TQ vario (basic model) Room temperature control with Q-Tech**

Pipe connection	G 3/4	Room temperature control	Yes
Presetting	Yes	Return temperature control	No
Cover	No	Venting	Yes
Q-Tech	Yes		

Operation	Item No.
Without	1022729

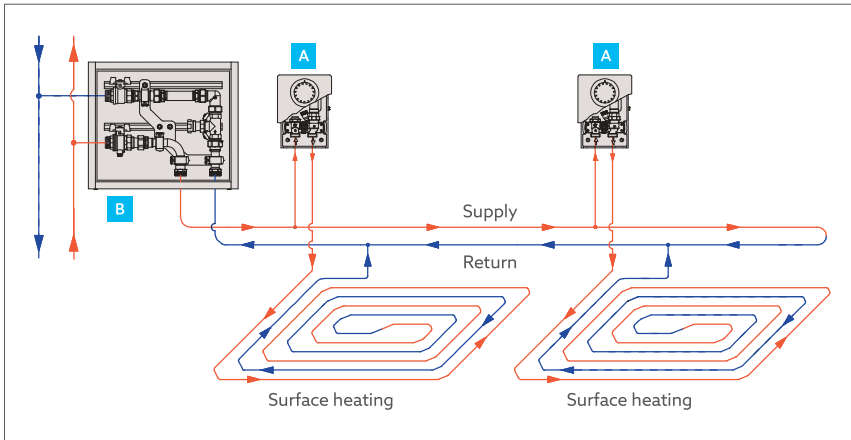

**Installation example**  
**Unidis Surface heating system**

<b>A</b>	<b>Unibox E BV</b> Room temperature control	1022724/25
<b>B</b>	<b>Floorbox UV / UH</b> for the connection of surface heating systems without distributor/collector	1022668/69

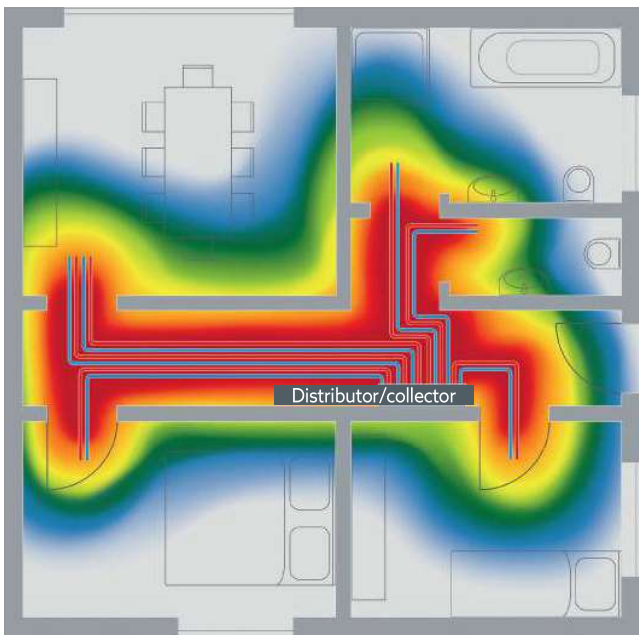

Conventional installation with heating circuit distributor/collector

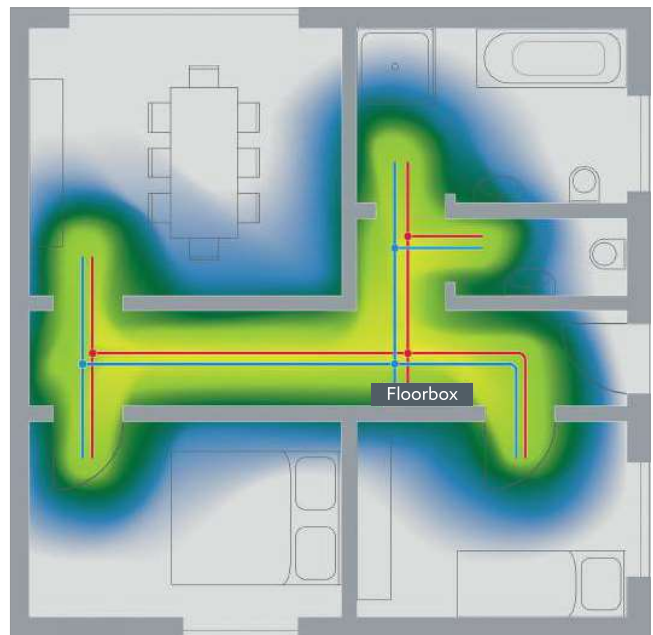

Unidis surface heating system with decentralised distribution



# Unidis - Accessories and spare parts



## Mounting channel

### Description

For Unibox, made of galvanised sheet steel, with cover made of gypsum board, H: 275-350 mm, W: 130 mm

For Unibox, with return shutoff, with cover and thermostat with remote control

For Unibox, made of galvanised sheet steel, H: 440-490 mm, W: 160 mm

### Item No.

1022652

1022654

1022653

## Extended cover, closed, genuine glass, white

### Description

For Unibox in combination with the mounting channel

### Item No.

1022755 ::



## Cofit S Compression fitting for G 3/4 external thread

Cofit S, 2-fold, for G 3/4 external thread according to DIN EN 16313, clamping ring and union nut made of brass, union nut nickel plated, metal to metal sealing plus O-ring.

Seal Metal to metal sealing

Suitable for - Multi-layer composite pipes  
 - Plastic pipes

### Suitable for pipe dimension (mm)

14 x 2.0

16 x 2.0

17 x 2.0

18 x 2.0

20 x 2.0

20 x 2.5

### Connection size

G 3/4 union nut

G 3/4 union nut

G 3/4 union nut

G 3/4 union nut

G 3/4 union nut

G 3/4 union nut

### Quantity

2-fold

2-fold

2-fold

2-fold

2-fold

2-fold

### Item No.

1507934

1507935

1507937

1507938

1507939

1507940





**Ofix CEP for G 3/4 external thread according to DIN EN 16313, soft sealing**

Ofix CEP, 2-fold, one-piece pre-assembled, for copper pipes according to DIN EN 1057, precision steel pipes according to DIN EN 10305-1 / 2, stainless steel pipes and galvanised steel pipes, soft sealing (no support sleeves required).

Suitable for

- Copper pipes
- Precision steel pipes
- Stainless steel pipe
- Galvanised steel pipes

Suitable for pipe dimension (mm)	Connection size	Seal	Quantity	Item No.
14 x 2.0	G 3/4 union nut x 10 mm	Soft sealing	2-fold	1016840
16 x 2.0	G 3/4 union nut x 12 mm	Soft sealing	2-fold	1016841
18 x 2.0	G 3/4 union nut x 14 mm	Soft sealing	2-fold	1016842
20 x 2.5	G 3/4 union nut x 15 mm	Soft sealing	2-fold	1016843
20 x 2.0	G 3/4 union nut x 16 mm	Soft sealing	2-fold	1016844
22 x 2.0	G 3/4 union nut x 18 mm	Soft sealing	2-fold	1016845



**Pipe connection press elbow**

Description	Item No.
For Unibox, for pipe connection through the mounting channel, 16 x 2.0 mm	1515353
For Unibox, for pipe connection through the mounting channel, 20 x 2.5 mm	1515356



**ClimaCon F 90 Room thermostat (heating only/cooling only)**

For Unibox T vario, TQ vario, T-RTL vario, TQ-RTL vario and E BV vario.

Tension	Control	Suitable for	Item No.
230 V AC	PWM	Electrothermal actuators "normally closed" (heating) Electrothermal actuators "normally open" (cooling)	1155009



**ClimaCon F 210 Room thermostat (heating only/cooling only)**

For Unibox T vario, TQ vario, T-RTL vario, TQ-RTL vario and E BV vario.

Tension	Control	Suitable for	Item No.
230 V AC	Two point / PWM	Electrothermal actuators (two point) "normally closed"	1155021



**Aktor T 2P Electrothermal actuator**

For Unibox T vario, TQ vario, T-RTL vario, TQ-RTL vario and E BV vario.

**Description**

Two point control, "normally closed", 230 V

**Item No.**

1012415



**Uni FHU Thermostat with remote control**

**Description**

- White, 2 m capillary tube
- White, 5 m capillary tube
- White, 10 m capillary tube

**Item No.**

- 1012595
- 1012596
- 1012597



**Replacement cover for Unibox T, T-RTL, TQ-RTL and E BV**

**Description**

- Plastic white
- Genuine glass white
- Genuine glass black

**Item No.**

- 1022779
- 1022777
- 1022778